



Spark ARENA

# VIP SPACES



VIP 1

VIP 2

VIP 3

MEZZANINE SUITES 1 & 2

THE GREAT SOUTH PACIFIC TUNING FORK

# VIP 1



VIP 1 is a large, very private space on our plaza level which holds up to 60 people in a cocktail setting. It is accessed direct from the outside plaza area via its own private entry, Door A. We can even roll out the red carpet if you wish!

This spacious suite has a large bar and catering area with plenty of space for buffet tables if required. Bar leaners and stools make for cosy social seating for your guests, and there's also a comfy lounging area complete with 42-inch plasma TV and DVD player for those who prefer to show a movie, or perhaps music videos. The in-room sound system can play radio or CDs from our central system, or you can bring in your own personal music player to plug in, and set the mood for your clients.

A private bathroom within the suite ensures that guests never need leave the confines of your area until it's show time, but additional bathroom facilities are located close by if required. This suite also offers the closest access to the building's elevator, for easy access to and from your seats.

CAPACITY PER USE:	Cocktail Reception (50)
	Dining (30)
	Presentation (40)
	Board Room (30)

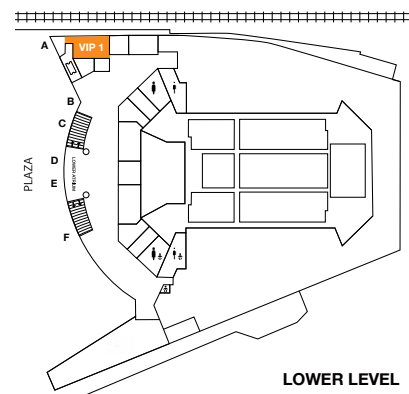
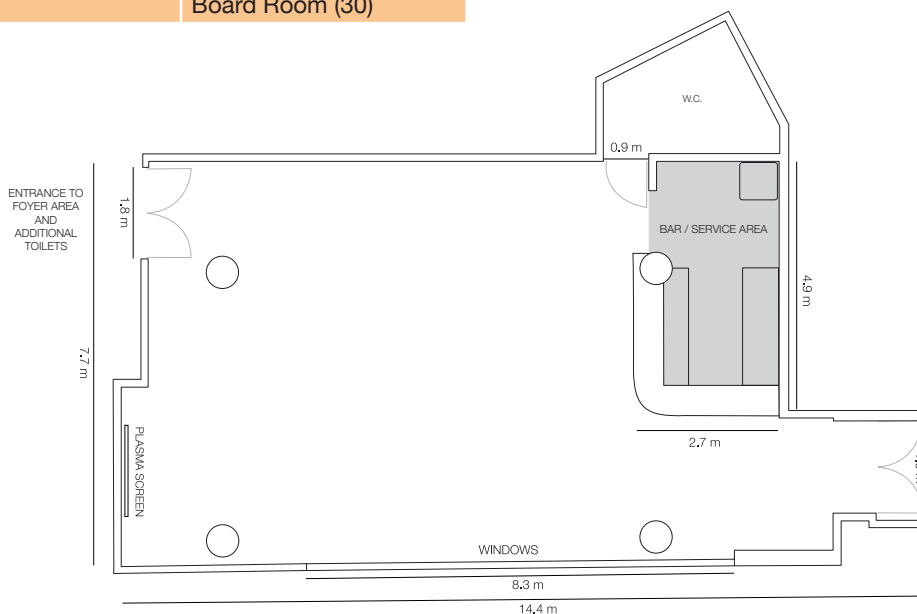

EXCLUSIVE USE OF ENTRY DOOR A FROM THE MAIN PLAZA

# VIP 2



VIP 2 is one of our two intimate private bar spaces, at the north side of the Atrium. It is directly accessed from the ground floor foyer, where the entrance is hidden by our blue velvet drapes, and upholstered screens.

Use of this suite includes private, pre-show meet-and-greet entry through Door E on our front plaza. This intimate space holds 30 people for cocktails, creating a perfect atmosphere for a smaller group.

The room features private bathroom facilities and a bar. It is decorated in an eclectic style, featuring memorabilia from past shows at the arena. VIP 2 has a pale and ethereal style. Furniture includes bar leaners and bar stools. Lighting is intimate, and clients have the choice of sound systems, using Spotify, CDs, radio or their own personal music player.

**CAPACITY PER USE:** Cocktail Reception (30)

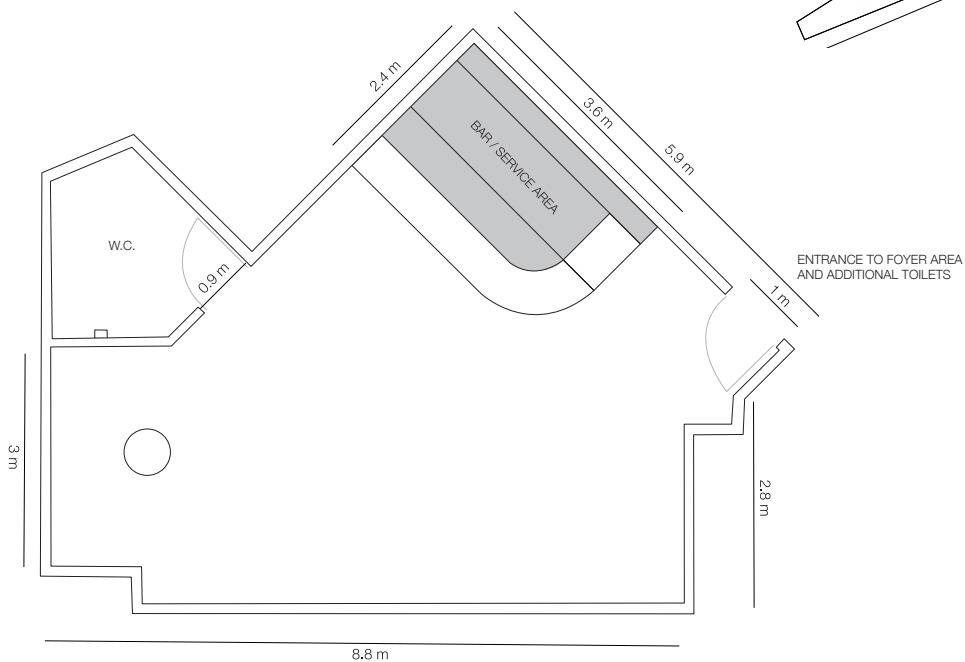
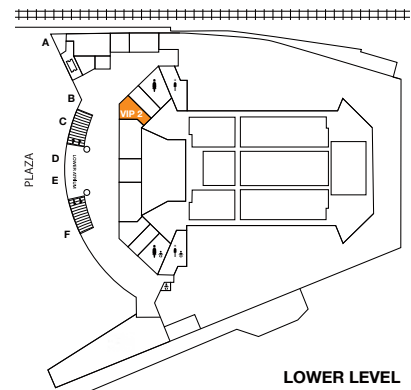

# VIP 3



VIP 3 is one of our two intimate private bar spaces, at the north side of the Atrium. It is directly accessed from the ground floor foyer, where the entrance is hidden by our blue velvet drapes, and upholstered screens.

Use of this suite includes private, pre-show meet-and-greet entry through Door E on our front plaza. This intimate space holds 30 people for cocktails, creating a perfect atmosphere for a smaller group.

The room features private bathroom facilities and a bar. It is decorated in an eclectic style, featuring memorabilia from past shows at the arena. VIP 3 has an assertive red, rock feel to it. Furniture includes bar leaners and bar stools. Lighting is intimate, and clients have the choice of sound systems, using Spotify, CDs, radio or their own personal music player.

**CAPACITY PER USE:** Cocktail Reception (30)

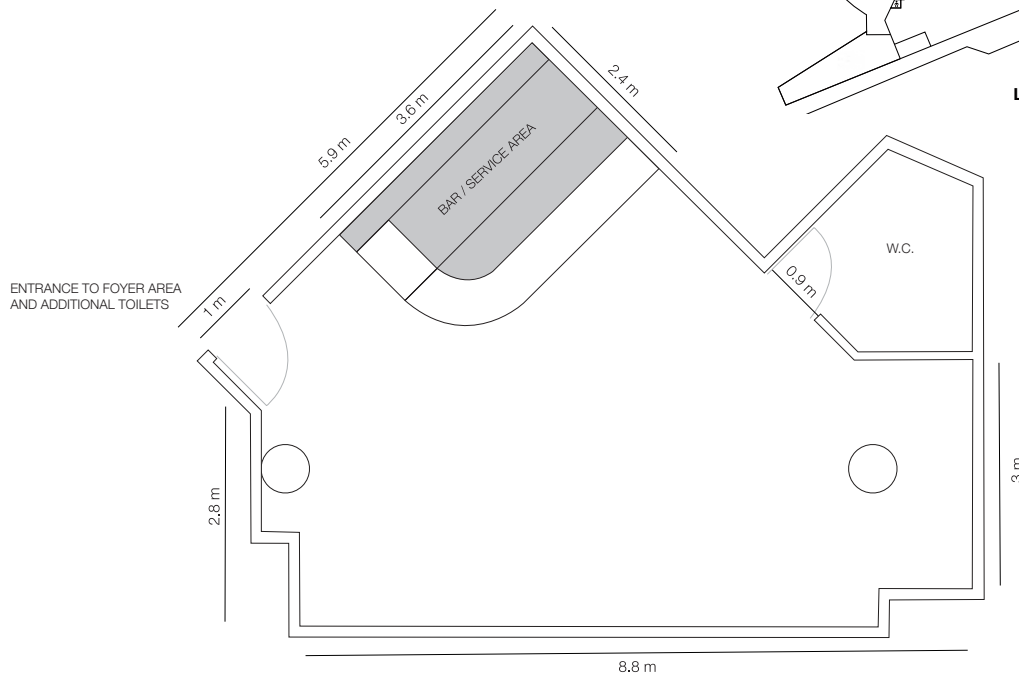
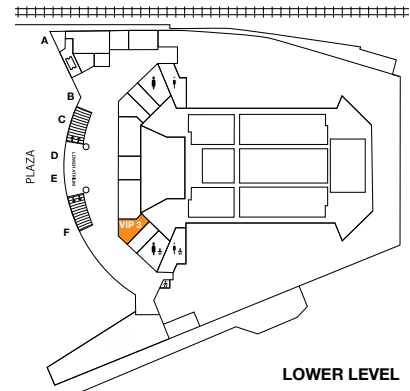



# MEZZANINE SUITES 1 & 2



The Mezzanine Suites are found towards the back of house area of the upstairs level. Each room holds up to 60 guests, but the two rooms can also be opened up to create a large space for 120. There are 42" plasma TVs and stereo systems in place and a mix of bar tables and stools and lounge style couch/chair areas. Each suite has two private bathrooms.

The unique location of these suites gives guests a great VIP, backstage feel as they are escorted along the mezzanine area above the stage to get there. However, due to their location, they are not available for every event at Spark Arena, with access being dependent on the nature of the setup for each specific show. Please ask about their availability at the time of your enquiry.

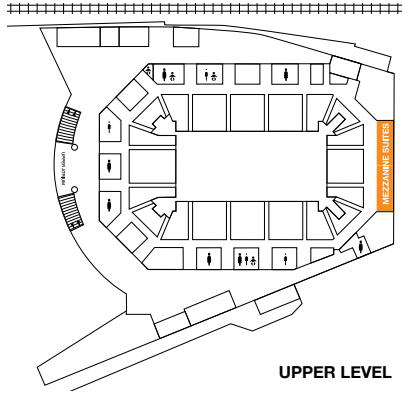

CAPACITY PER USE: Mezzanine Suite 1 (60)  
Mezzanine Suite 2 (60)

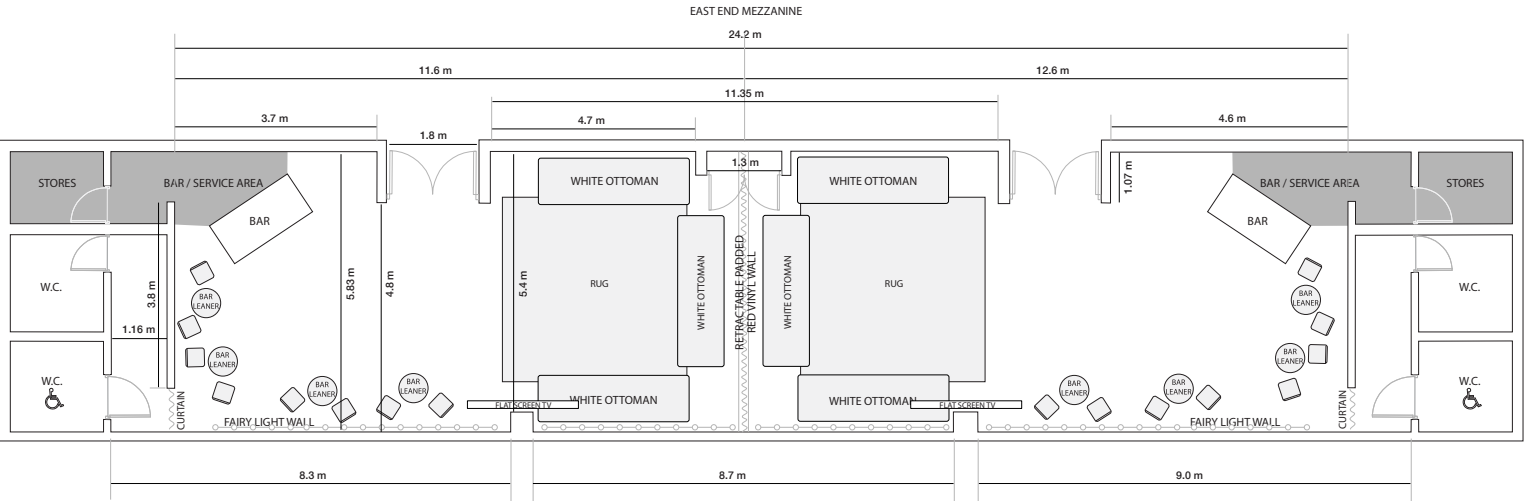

# THE GREAT SOUTH PACIFIC TUNING FORK

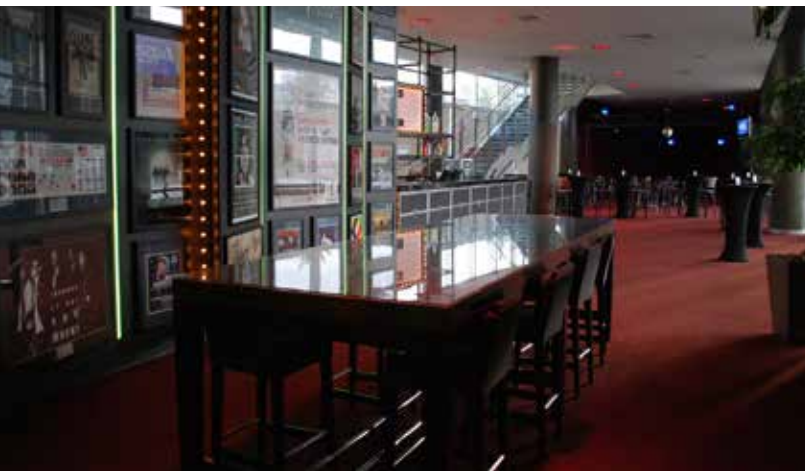

The Tuning Fork is a self-contained events space with frontage onto Spark Arena's main plaza. Visible from Mahuhu Crescent, it's connected to the arena's atrium at the southern side of the building.

It's an easy stroll from the city centre through Britomart, offering great access to public transport, with local car parking also only a few minutes walk away.

While it's affectionately referred to as our "baby arena", The Tuning Fork offers the full expertise and technical support of all our arena staff, including management and marketing backup.

We can have your clients name up in lights as they arrive, with our eye catching welcome sign above the bar area.

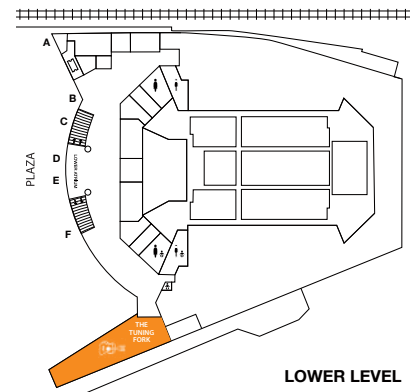

CAPACITY PER USE: Cocktail Reception (250)

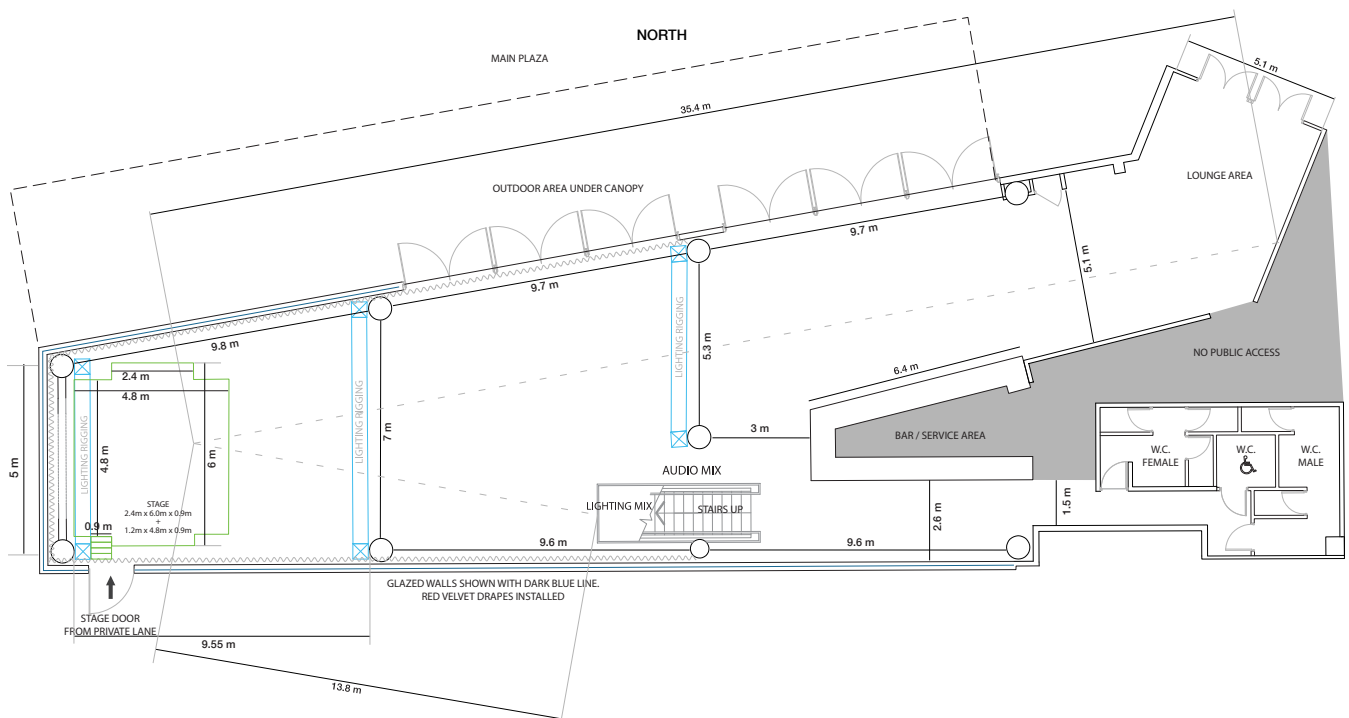

**For more information please contact:**

COURTNEY JACKSON  
CORPORATE SALES & EVENT MANAGER  
[info@sparkarena.co.nz](mailto:info@sparkarena.co.nz)  
Tel: 09 358 1250

Spark Arena  
42 - 80 Mahuhu Crescent  
Parnell, Auckland